

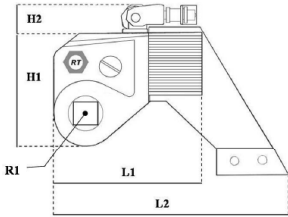

HYDRAULIC TORQUE WRENCH – SQUARE DRIVE – RT SERIES



Model >	RT-1	RT-3	RT-5	RT-8	RT-10	RT-20	RT-25	RT50
Sq Drive	¾"	1"	1-1/2"	1-1/2"	1-1/2"	2-1/2"	2-1/2"	2-1/2"
Ft Lbs- Min	200	480	835	1,200	1,700	2,960	3,960	7,875
Ft Lbs- Max	1,390	3,230	5,590	8,000	11,520	19,760	25,890	52,500
Weight - kg	1.9	3.9	7.5	11.5	13.4	24.7	31	60
Accuracy	3%							
L 1	120	155	185	202	232	259	310	390
L 2	183	237	288	321	357	420	473	615
H 1	0.59	120	144.5	164.6	186	216	234	294
H 2	122	156	181	213.3	239	251	282	344
R 1	23	33	37	41	48	55.1	61	79
W 1	50	66.5	80	88	100	119	134	167
W 2	71	95.5	126	126	142.5	170	191	228

RT SERIES – ULTIMATE POWER TO WEIGHT TORQUE SOLUTIONS

Hose Swivel – Horizontal & Vertical adjustment. Safest hose position. Not Fixed.

Reaction Arm – Fully adjustable. Not Fixed. 6° Increments, Deep Sockets etc ..

Course Tooth Ratchet – Proven necessity. Reliable ratchet tooth engagement.

Light Weight Air Craft Alloy – not steel, weight does matter.

Power To Weight – Nothing Compares

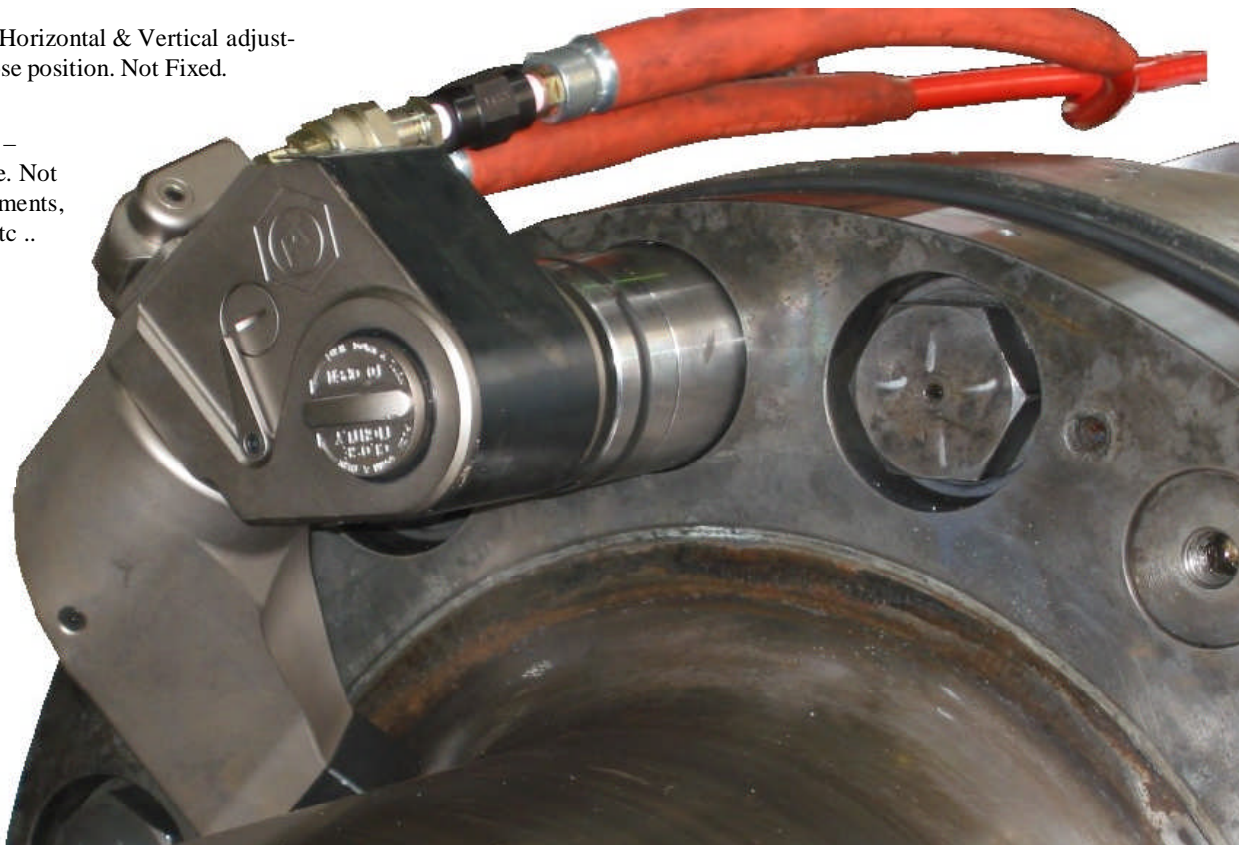

RT SERIES – Dedicated square & hex drive, hydraulic torque wrench, for use with Impact Sockets. These tools are designed for serious heavy industry users. Fully adjustable reaction for maximum reaction options. Rapidtorc's aim is not to limit tool usability, but increase it. The Rapidtorc RT torque wrenches have evolved over 25 years using hands on industry knowledge. Proven design, tough, reliable & well backed. Smallest, lightest most powerful torque tool option in the world. Australian South Pacific Supported. When it needs to fit – Rapid-Torc is the answer

Distributed by:

TJ Tools
www.tjtools.com.au
 WA: 0418 802 973
 QLD: 0431 700 198
 SA /VIC: 0439 188 400
 NSW 0418 421 654